

**STREET LIGHT DETAILS**  
 TYPE A - 7.5m VICPOLE 125mm SQUARE SERIES COLUMN HOT DIPPED GALV, TWO PACT BLACK PAINT FINISH. CREE EDGE SQUARE SERIES XAL 1304C-UT LED LIGHT FIXTURE. 40 WATT LED (525MA DRIVER), TYPE 3M OPTICS

	mN	mE	
SL109	758593.53	421319.06	TYPE A
SL110	758552.22	421349.79	TYPE A
SL111	758504.10	421384.03	TYPE A
SL112	758456.80	421415.40	TYPE A
SL113	758468.86	421452.46	TYPE A
SL114	758510.38	421497.27	TYPE A
SL115	758538.10	421499.23	TYPE A
SL116	758584.91	421462.74	TYPE A
SL117	758618.21	421412.35	TYPE A
SL118	758575.24	421368.09	TYPE A

I, MICHAEL STEPHEN SMITH, MIPENZ CPENG HEREBY BELIEVE ON ALL REASONABLE GROUNDS THAT THE LOCATIONS OF KERBS, CHANNELS, STREET LIGHTS AND FOOTPATHS ARE ACCURATELY PLOTTED IN RELATION TO BOUNDARIES AND IS CORRECT AS THIS INFORMATION HAS BEEN PROVIDED BY THE CONTRACTOR OF THE WORKS - KERRY DINES LTD.

-----  
 MICHAEL STEPHEN SMITH      DATE  
 MIPENZ CPENG

**NOTES**

- ALL COORDINATES ARE IN METRES AND IN TERMS OF GEODETIC 2000 MT. EDEN
- ALL LEVELS ARE IN METRES AND IN TERMS OF THE LANDS AND SURVEY DATUM (MEAN SEA LEVEL) AUCKLAND 1946

**LEGEND**

	STD. KERB		EDGE OF SEAL TRANSITION TO EXISTING
	KERB & NIB		TO EXISTING
	MOUNTABLE KERB		STREET LIGHTS
	CHANNEL		DRIVEWAY
	FOOTPATH		
	CHIPSEAL ONLY		

REV	REVISION DETAILS	BY	DATE

PLOTTED: RJP      DATE: 06-21  
 DRAWN: RJP      DATE: 06-21  
 APPROVED: MSS      DATE: 06-21

THIS DRAWING AND DESIGN REMAINS THE PROPERTY OF, AND MAY NOT BE REPRODUCED OR ALTERED, WITHOUT THE WRITTEN PERMISSION OF CIVILPLAN CONSULTANTS LIMITED. NO LIABILITY SHALL BE ACCEPTED FOR UNAUTHORISED USE OF THIS DRAWING.

**CIVILPLAN CONSULTANTS**

Level 3 AMI Building, 15 Osterley Way, Manukau City. Phone: 2222445

PROJECT TITLE:  
 DFH JOINT VENTURE  
 HITCHEN STAGE 13A SUBDIVISION  
 POKENO

SHEET TITLE:  
 STAGES 13A1 & 13A2  
 AS BUILT ROADING

ISSUE STATUS: **AS BUILT**

SCALE: (A1/A3) 1:500 / 1:1000

SCALE BAR 0 10 20 30 40 50m

DRAWING NUMBER: **126701-13-AB300** REV: **A**

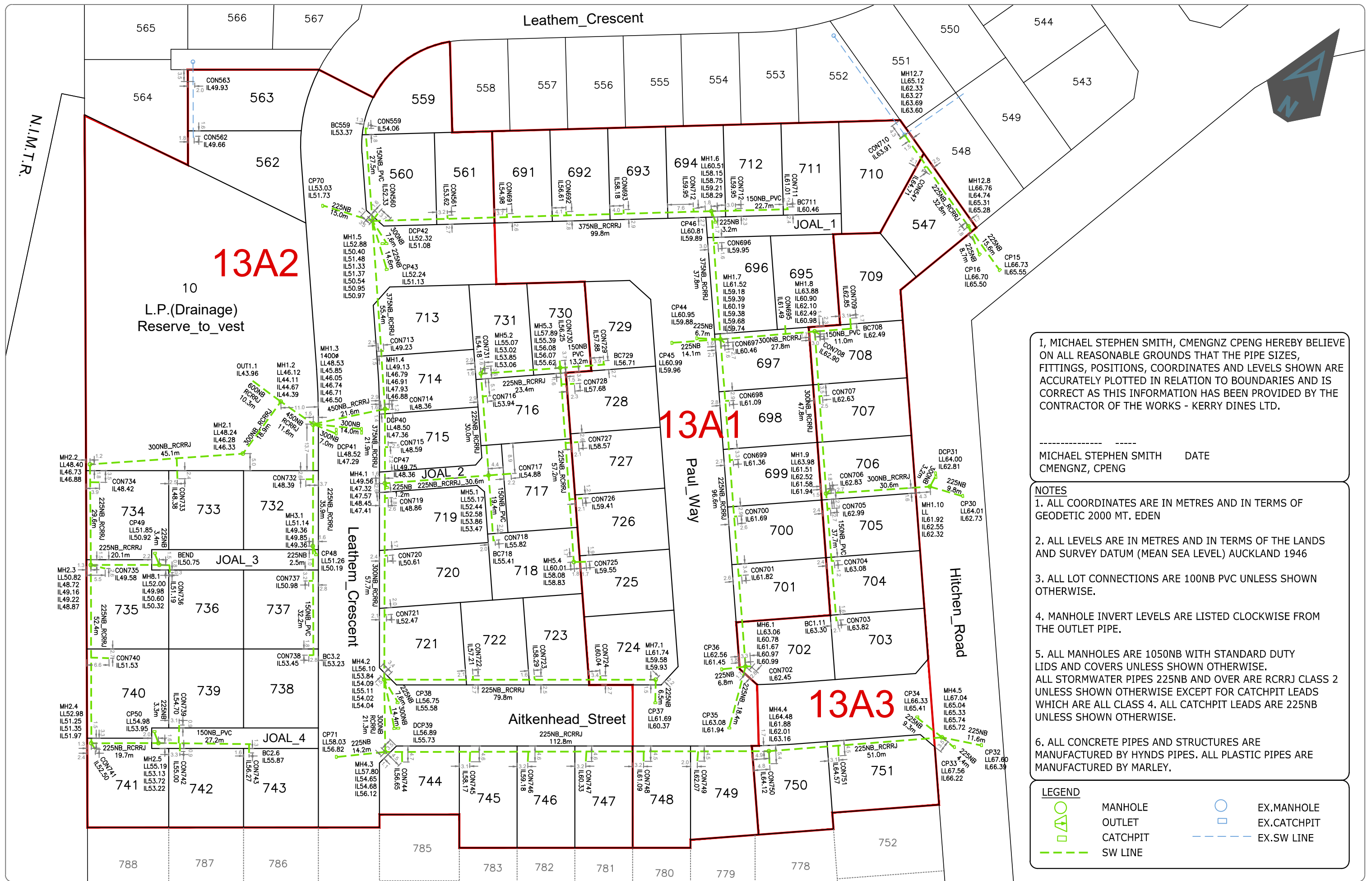

I, MICHAEL STEPHEN SMITH, CMENGNZ CPENG HEREBY BELIEVE ON ALL REASONABLE GROUNDS THAT THE PIPE SIZES, FITTINGS, POSITIONS, COORDINATES AND LEVELS SHOWN ARE ACCURATELY PLOTTED IN RELATION TO BOUNDARIES AND IS CORRECT AS THIS INFORMATION HAS BEEN PROVIDED BY THE CONTRACTOR OF THE WORKS - KERRY DINES LTD.

-----  
 MICHAEL STEPHEN SMITH      DATE  
 CMENGNZ, CPENG

- NOTES**
1. ALL COORDINATES ARE IN METRES AND IN TERMS OF GEODETIC 2000 MT. EDEN
  2. ALL LEVELS ARE IN METRES AND IN TERMS OF THE LANDS AND SURVEY DATUM (MEAN SEA LEVEL) AUCKLAND 1946
  3. ALL LOT CONNECTIONS ARE 100NB PVC UNLESS SHOWN OTHERWISE.
  4. MANHOLE INVERT LEVELS ARE LISTED CLOCKWISE FROM THE OUTLET PIPE.
  5. ALL MANHOLES ARE 1050NB WITH STANDARD DUTY LIDS AND COVERS UNLESS SHOWN OTHERWISE. ALL STORMWATER PIPES 225NB AND OVER ARE RCRRJ CLASS 2 UNLESS SHOWN OTHERWISE EXCEPT FOR CATCHPIT LEADS WHICH ARE ALL CLASS 4. ALL CATCHPIT LEADS ARE 225NB UNLESS SHOWN OTHERWISE.
  6. ALL CONCRETE PIPES AND STRUCTURES ARE MANUFACTURED BY HYNDS PIPES. ALL PLASTIC PIPES ARE MANUFACTURED BY MARLEY.

**LEGEND**

	MANHOLE		EX.MANHOLE
	OUTLET		EX.CATCHPIT
	CATCHPIT		EX.SW LINE
	SW LINE		

REV	REVISION DETAILS	BY	DATE

PLOTTED: RJP	DATE: 06-21
DRAWN: RJP	DATE: 06-21
APPROVED: MSS	DATE: 06-21

THIS DRAWING AND DESIGN REMAINS THE PROPERTY OF, AND MAY NOT BE REPRODUCED OR ALTERED, WITHOUT THE WRITTEN PERMISSION OF CIVILPLAN CONSULTANTS LIMITED. NO LIABILITY SHALL BE ACCEPTED FOR UNAUTHORISED USE OF THIS DRAWING.

**CIVILPLAN CONSULTANTS**  
 Level 3 AMI Building, 15 Osterley Way, Manukau City. Phone: 2222445

PROJECT TITLE:  
 DFH JOINT VENTURE  
 HITCHEN STAGE 13A SUBDIVISION  
 POKENO

SHEET TITLE:  
 AS BUILT STORMWATER DRAINAGE

ISSUE STATUS: **AS BUILT**

SCALE: (A1/A3) 1:500 / 1:1000

SCALE BAR 0 10 20 30 40 50m

DRAWING NUMBER: **126701-13-AB400** REV: **A**

Filepath: P:\APPDATA\LOCAL\AUTODESK\CAD 2020\ENU\TEMPLATE C:\DATA\POKENO\HITCHEN\STAGE 13\AS BUILT\136701-13A-AB400.DWG

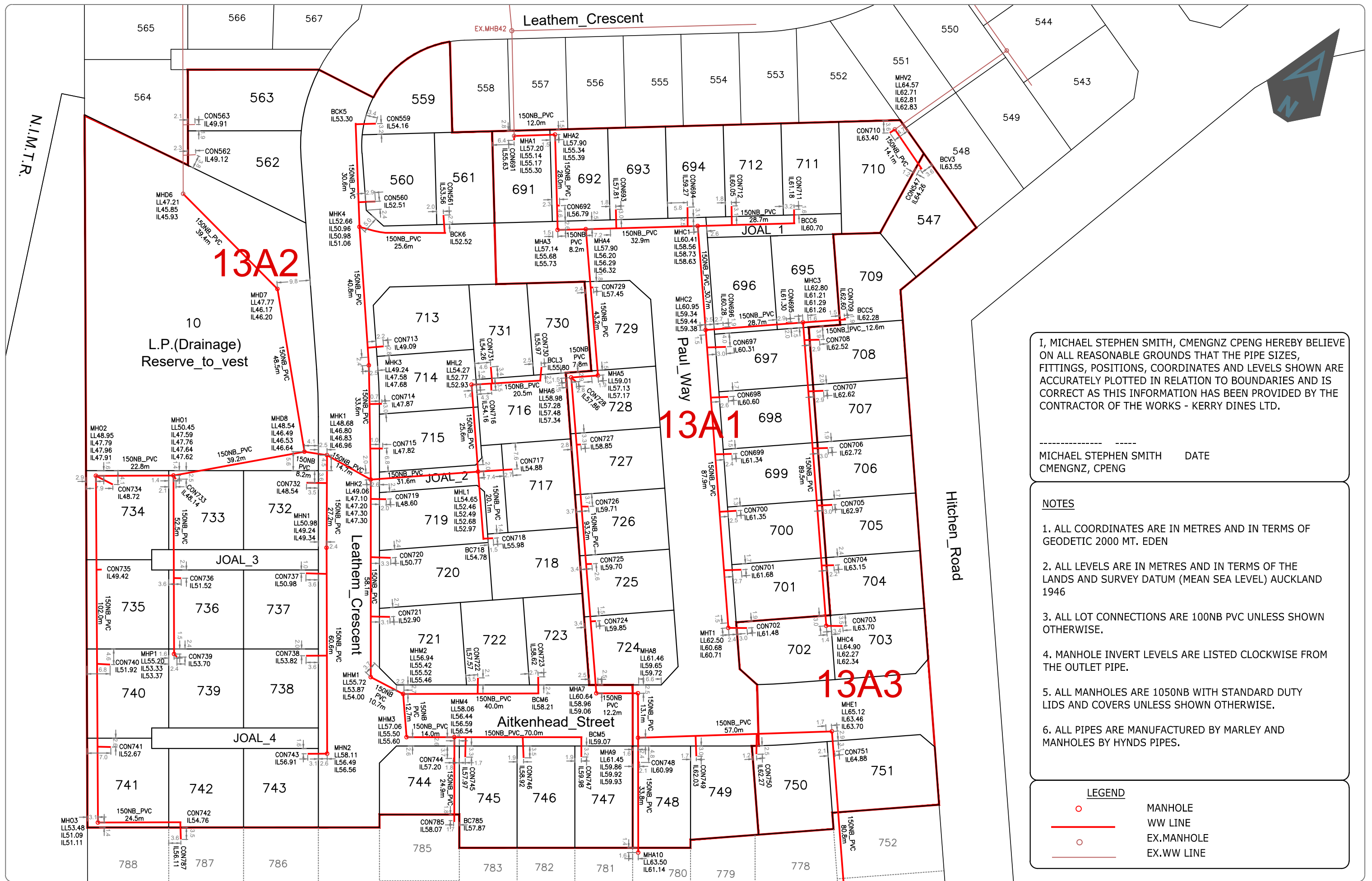

I, MICHAEL STEPHEN SMITH, CMENGNZ CPENG HEREBY BELIEVE ON ALL REASONABLE GROUNDS THAT THE PIPE SIZES, FITTINGS, POSITIONS, COORDINATES AND LEVELS SHOWN ARE ACCURATELY PLOTTED IN RELATION TO BOUNDARIES AND IS CORRECT AS THIS INFORMATION HAS BEEN PROVIDED BY THE CONTRACTOR OF THE WORKS - KERRY DINES LTD.

-----  
 MICHAEL STEPHEN SMITH      DATE  
 CMENGNZ, CPENG

- NOTES**
1. ALL COORDINATES ARE IN METRES AND IN TERMS OF GEODETIC 2000 MT. EDEN
  2. ALL LEVELS ARE IN METRES AND IN TERMS OF THE LANDS AND SURVEY DATUM (MEAN SEA LEVEL) AUCKLAND 1946
  3. ALL LOT CONNECTIONS ARE 100NB PVC UNLESS SHOWN OTHERWISE.
  4. MANHOLE INVERT LEVELS ARE LISTED CLOCKWISE FROM THE OUTLET PIPE.
  5. ALL MANHOLES ARE 1050NB WITH STANDARD DUTY LIDS AND COVERS UNLESS SHOWN OTHERWISE.
  6. ALL PIPES ARE MANUFACTURED BY MARLEY AND MANHOLES BY HYNDS PIPES.

LEGEND	
	MANHOLE
	WW LINE
	EX.MANHOLE
	EX.WW LINE

REV	REVISION DETAILS	RJP	DATE
B	LEAD TO LOT 718 ADDED	RJP	29-9-21

PLOTTED:	DATE:	THIS DRAWING AND DESIGN REMAINS THE PROPERTY OF, AND MAY NOT BE REPRODUCED OR ALTERED, WITHOUT THE WRITTEN PERMISSION OF CIVILPLAN CONSULTANTS LIMITED. NO LIABILITY SHALL BE ACCEPTED FOR UNAUTHORISED USE OF THIS DRAWING.
RJP	06-21	
DRAWN:	DATE:	
RJP	06-21	
APPROVED:	DATE:	
MSS	06-21	

**CIVILPLAN CONSULTANTS**  
 Level 3 AMI Building, 15 Osterley Way, Manukau City. Phone: 2222445

PROJECT TITLE:  
**DFH JOINT VENTURE  
 HITCHEN STAGE 13A SUBDIVISION  
 POKENO**

SHEET TITLE:  
**AS BUILT WASTE WATER DRAINAGE**

ISSUE STATUS: **AS BUILT**

SCALE: (A1/A3) **1:500 / 1:1000**

SCALE BAR: 0 10 20 30 40 50m

DRAWING NUMBER: **126701-13-AB401** REV: **B**

Filepath: P:\APPDATA\LOCAL\AUTODESK\CAD 2020\ENV\TEMPLATE C:\DATA\POKENO\HITCHEN\STAGE 13\AS BUILT\136701-13A-AB401.DWG

WASTEWATER COORDINATES

MH=MANHOLE, BC=BLANK CAP  
CON=LOT CONNECTION

MHA1	758623.79	421368.83
MHA2	758630.77	421378.65
MHA3	758607.82	421394.78
MHA4	758612.58	421401.54
MHA5	758578.70	421428.33
MHA6	758573.84	421422.14
MHA7	758500.47	421479.64
MHA8	758507.27	421489.83
MHA9	758496.37	421497.12
MHA10	758468.22	421515.82
MHC1	758631.57	421428.47
MHC2	758607.38	421447.35
MHC3	758625.03	421469.98
MHC4	758554.43	421525.05
BCC5	758632.77	421480.02
BCC6	758648.08	421451.94
MHD6	758555.79	421297.12
MHD7	758547.77	421335.69
MHD8	758512.28	421368.79
MHE1	758529.44	421543.60
MHE2	758465.70	421593.31
MHK1	758515.08	421374.87
MHK2	758516.23	421389.59
MHK3	758543.92	421370.55
MHK4	758576.35	421345.71
BCK5	758601.19	421327.85
BCK6	758588.93	421367.88
MHL1	758535.60	421414.58
MHL2	758555.88	421398.85
BCL3	758568.23	421415.24
MHM1	758467.79	421421.72
MHM2	758468.88	421432.40
MHM3	758458.85	421440.28
MHM4	758466.64	421451.99
BCM5	758487.44	421483.34
BCM6	758491.19	421465.66
MHN1	758492.32	421389.82
MHN2	758441.90	421423.48
MHO1	758485.13	421340.55
MHO2	758472.43	421321.60
MHO3	758387.76	421378.48
MHP1	758441.44	421369.75
MHT1	758538.01	421501.37
MHV2	758687.31	421461.12
BCV3	758681.98	421474.18
MHW1		

WASTEWATER COORDINATES

MH=MANHOLE, BC=BLANK CAP  
CON=LOT CONNECTION

CON547	758681.63	421473.67
CON559	758604.32	421332.94
CON560	758585.17	421345.47
CON561	758592.89	421364.36
CON562	758567.41	421293.84
CON563	758574.69	421288.75
CON691	758622.71	421369.52
CON692	758614.12	421391.34
CON693	758622.29	421405.71
CON694	758634.50	421422.89
CON695	758622.46	421465.92
CON696	758610.90	421451.21
CON697	758606.52	421455.05
CON698	758594.65	421463.75
CON699	758581.19	421473.89
CON700	758568.08	421484.30
CON701	758554.37	421495.08
CON702	758540.97	421505.96
CON703	758557.03	421529.09
CON704	758570.51	421517.05
CON705	758585.04	421506.82
CON706	758598.32	421496.50
CON707	758611.60	421486.09
CON708	758623.48	421476.82
CON709	758632.91	421479.42
CON710	758685.62	421460.38
CON711	758651.28	421449.40
CON712	758641.95	421433.52
CON713	758550.98	421371.06
CON714	758536.62	421379.98
CON715	758525.77	421387.46
CON716	758557.68	421404.66
CON717	758541.78	421422.65
CON718	758521.72	421429.11
CON719	758513.91	421396.55
CON720	758500.27	421407.21
CON721	758485.66	421416.61
CON722	758485.03	421448.09
CON723	758495.07	421462.71
CON724	758518.15	421467.80
CON725	758531.49	421457.49
CON726	758545.01	421447.35
CON727	758558.99	421435.37
CON728	758573.55	421424.04
CON729	758599.51	421412.89
CON730	758571.59	421413.10
CON731	758563.37	421400.66
CON732	758504.98	421374.36
CON733	758484.62	421341.76
CON734	758473.06	421327.14
CON735	758450.40	421338.28
CON736	758461.18	421359.13
CON737	758482.70	421388.93
CON738	758462.42	421402.24
CON739	758441.16	421370.92
CON740	758428.44	421355.76
CON741	758408.36	421369.34
CON742	758401.38	421398.89
CON743	758438.71	421418.74
CON744	758461.22	421455.14
CON745	758463.52	421457.88
CON746	758472.83	421472.28
CON747	758482.43	421486.30
CON748	758490.58	421501.53
CON749	758501.30	421514.41
CON750	758511.57	421528.80
CON751	758525.01	421547.53
CON785	758446.03	421465.37

STORMWATER COORDINATES

MH=MANHOLE, BC=BLANK CAP  
CON=LOT CONNECTION

OUT1.1	758521.21	421344.54
MH1.2	758520.69	421354.86
MH1.3	758520.46	421366.45
MH1.4	758535.85	421381.57
MH1.5	758579.89	421347.91
MH1.6	758637.43	421429.43
MH1.7	758607.48	421452.49
MH1.8	758624.73	421474.33
MH1.9	758586.84	421503.49
MH1.10	758605.42	421527.83
MH2.1	758501.77	421354.02
MH2.2	758474.28	421318.27
MH2.3	758449.75	421334.86
MH2.4	758406.10	421363.97
MH2.5	758417.08	421380.39
BC2.6	758431.86	421403.24
MH3.1	758490.46	421386.23
BC3.2	758463.72	421404.16
MH4.1	758517.58	421393.66
MH4.2	758469.34	421425.42
MH4.3	758451.77	421437.44
MH4.4	758514.37	421531.37
MH4.5	758545.90	421571.54
MH5.1	758536.42	421417.80
MH5.2	758560.10	421399.36
MH5.3	758574.41	421417.85
MH5.4	758529.03	421452.77
MH6.1	758531.31	421511.87
MH7.1	758513.45	421491.98
MH8.1	758460.92	421351.63
MH12.7	758687.54	421464.38
MH12.8	758675.49	421494.88
BC559	758601.66	421331.01
BC708	758631.49	421482.98
BC711	758650.44	421448.02
BC718	758521.03	421429.69
BC729	758582.52	421428.30
CP15	758669.81	421509.94
CP16	758670.48	421502.00
CP30	758608.63	421537.58
DCP31	758608.58	421527.49
CP32	758550.55	421582.69
CP33	758545.38	421575.97
CP34	758546.66	421562.28
CP35	758513.38	421518.03
CP36	758526.92	421506.68
CP37	758507.95	421495.50
CP38	758466.06	421432.31
DCP39	758458.80	421436.01
DCP40	758527.28	421379.30
DCP41	758521.78	421373.39
DCP42	758576.82	421354.88
CP43	758570.12	421359.47
CP44	758604.05	421446.74
CP45	758598.56	421440.93
CP46	758635.58	421432.03
CP47	758516.65	421395.01
CP48	758489.09	421388.29
CP49	758463.27	421348.49
CP50	758419.47	421377.40
CP70	758575.36	421333.05
CP71	758442.44	421426.02

STORMWATER COORDINATES

MH=MANHOLE, BC=BLANK CAP  
CON=LOT CONNECTION

CON6	758870.89	421397.84
CON547	758682.55	421474.48
CON559	758601.81	421331.71
CON560	758582.63	421348.03
CON561	758593.49	421365.35
CON562	758571.67	421290.42
CON563	758585.20	421281.68
CON691	758603.55	421379.68
CON692	758613.68	421393.83
CON693	758623.53	421407.61
CPN694	758635.19	421424.51
CON695	758621.44	421466.03
CON696	758630.70	421436.16
CON697	758607.27	421454.01
CON698	758593.83	421464.65
CON699	758579.98	421475.20
CON700	758566.80	421485.36
CON701	758553.02	421496.08
CON702	758532.24	421513.13
CON703	758557.66	421526.94
CON704	758571.64	421516.43
CON705	758583.85	421506.97
CON706	758588.30	421503.88
CON707	758610.17	421486.68
CON708	758624.84	421475.93
CON709	758633.75	421480.87
CON710	758685.69	421463.78
CON711	758650.79	421447.35
CON712	758641.98	421434.91
CON713	758549.90	421371.85
CON714	758536.42	421382.71
CON715	758527.01	421388.53
CON716	758555.61	421404.50
CON717	758540.46	421422.98
CON718	758521.54	421429.90
CON719	758514.54	421396.86
CON720	758500.33	421406.06
CON721	758485.62	421415.44
CON722	758484.72	421446.54
CON723	758494.59	421461.66
CON724	758505.41	421477.74
CON725	758531.06	421455.68
CON726	758546.04	421444.47
CON727	758559.16	421434.36
CON728	758572.82	421423.91
CON729	758583.20	421427.34
CON730	758576.10	421416.55
CON731	758562.50	421399.17
CON732	758505.73	421373.62
CON733	758484.98	421342.03
CON734	758471.41	421323.50
CON735	758451.19	421338.94
CON736	758460.73	421355.48
CON737	758481.25	421390.87
CON738	758463.09	421402.94
CON739	758424.87	421382.53
CON740	758429.86	421354.45
CON741	758405.28	421365.94
CON742	758418.51	421387.00
CON743	758429.39	421404.19
CON744	758452.05	421443.21
CON745	758463.11	421459.75
CON746	758472.56	421473.98
CON747	758482.06	421488.17
CON748	758491.48	421502.30
CON749	758500.25	421515.45
CON750	758511.36	421533.58
CON751	758524.53	421549.21

WATER SUPPLY COORDINATES

FH=HYDRANT PV=PEET VALVE  
SV=SLUIJCE VALVE WM=WATER METER

SV211	758567.24	421334.30
SV212	758567.11	421334.76
SV213	758576.51	421347.38
PV214	758576.09	421347.55
PV215	758563.61	421357.83
SV216	758457.31	421411.56
SV217	758457.20	421412.05
PV218	758465.41	421425.07
SV219	758469.30	421430.29
PV220	758452.41	421434.38
PV221	758512.67	421495.24
SV222	758524.35	421513.08
SV223	758524.75	421513.17
PV224	758633.11	421428.05
FH225	758618.75	421440.25
FH226	758593.82	421372.06
FH227	758531.84	421361.60
FH228	758454.59	421413.34

WATER SUPPLY COORDINATES

WM559	758636.60	421336.92
WM560	758588.50	421364.13
WM561	758589.17	421365.15
WM562	758590.30	421316.80
WM563	758591.19	421316.19
WM691	758608.12	421392.02
WM692	758608.71	421392.81
WM693	758627.67	421419.79
WM694	758628.37	421420.69
WM695	758641.63	421448.30
WM696	758640.66	421446.68
WM697	758594.41	421459.89
WM698	758593.49	421460.49
WM699	758567.60	421480.55
WM700	758566.78	421481.17
WM701	758540.63	421501.49
WM702	758539.84	421502.13
WM710	758657.09	